



Brass Prong Snap

HISANAGA

Yotsukaido Industrial Park 598
 Monoi, Yotsukaido-shi Chiba 284-0012 JAPAN
 Tel +81(43)422 2112 · Fax +81(43)423 7147
 overseas.crown@hisanaga-ss.co.jp

B3782 Series

Meets the safety, design and reliability requirements of major buyers.

[Usage] Suitable general garments, especially for knitting and baby clothes.

TOP PARTS

PRONG



B3782A / LA

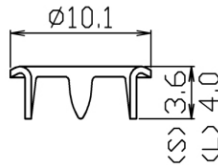

other combination



26A / 12mm



Poly / 10mm



B26 Donuts



27A / 15mm



Poly / 12mm



B27 Donuts

FABRIC

SOCKET



B3782B

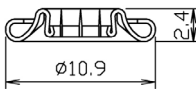

Combination of Top parts & Socket

Regular prong

Basic pinch	2.70mm
Max attached height	3.30mm
Holding strength	over 9.20kg

Long prong

Basic pinch	3.10mm
Max attached height	3.80mm
Holding strength	over 9.20kg

Combination of Socket & Stud(B3785CW)

Closing snap action	3.0 ~ 5.0kg
Opening snap action	0.9 ~ 1.3kg

Combination of Socket & Stud(B3783C)

Closing snap action	3.0 ~ 5.0kg
Opening snap action	1.1 ~ 1.6kg

STUD



B3785CW

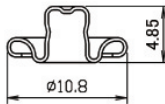

B3783C

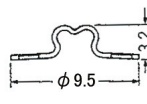

Combination of Under parts & Stud(B3785)

Regular prong

Basic pinch	2.70mm
Max attached height	3.30mm
Holding strength	over 9.20kg

Long prong

Basic pinch	3.10mm
Max attached height	3.80mm
Holding strength	over 9.20kg

Combination of Under parts & Stud(B3783)

Basic pinch	1.55mm
Max attached height	2.60mm
Holding strength	over 9.20kg

UNDER PARTS (3PARTS)

FABRIC

PRONG



B3782A / LA

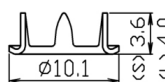

POST



B3784D

