



# Stainless Prong Snap

**HISANAGA**

Yotsukaido Industrial Park 598  
 Monoi, Yotsukaido-shi Chiba 284-0012 JAPAN  
 Tel +81(43)422 2112 · Fax +81(43)423 7147  
 overseas.crown@hisanaga-ss.co.jp

## ST-82 Series

Meets the safety, design and reliability requirements of major buyers.

**[Usage]** Using rust-resisting materials. Suitable for medical garments, working wear and so on.

TOP PARTS

### PRONG



ST-82A / LA

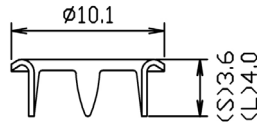

### other combination



ST26A / 12mm



ST27A / 15mm

### FABRIC

### SOCKET



ST-82B

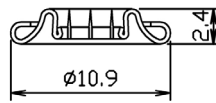

### Combination of Top parts & Socket

Regular prong	
Basic pinch	2.70mm
Max attached height	3.30mm
Holding strength	over 9.20kg
Long prong	
Basic pinch	3.10mm
Max attached height	3.80mm
Holding strength	over 9.20kg

UNDER PARTS (3PARTS)

### STUD



ST-85CW

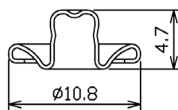

ST-82C

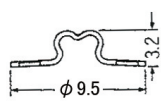

### Combination of Socket & Stud(ST-85CW)

Closing snap action	3.0 ~ 6.5kg
Opening snap action	1.3 ~ 1.8kg

### Combination of Socket & Stud(ST-82C)

Closing snap action	3.0 ~ 6.5kg
Opening snap action	1.4 ~ 1.9kg

### FABRIC

### PRONG



ST-82 / LA

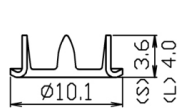

### POST



ST-82D

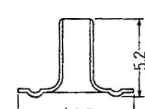

### Combination of Under parts & Stud

Regular prong	
Basic pinch	2.70mm
Max attached height	3.30mm
Holding strength	over 9.20kg
Long prong	
Basic pinch	3.10mm
Max attached height	3.80mm
Holding strength	over 9.20kg

### Combination of Under parts & Stud(ST-82)

Basic pinch	1.55mm
Max attached height	2.60mm
Holding strength	over 9.20kg